

# PLAN VIEW:

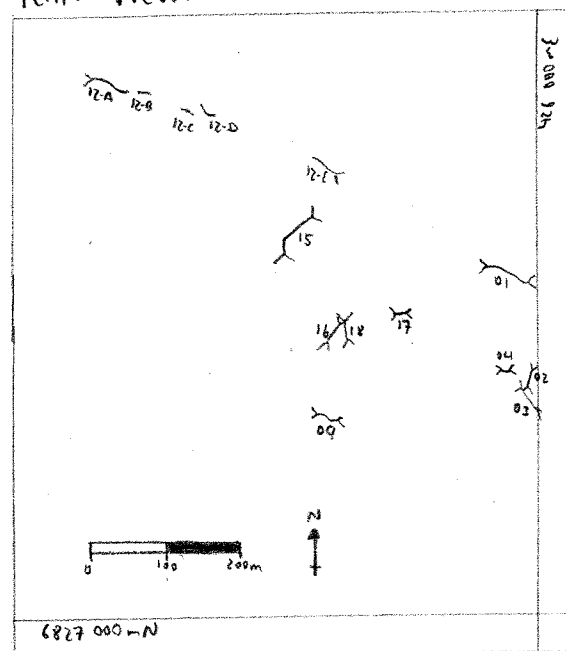

## STRING PROPERTY

TR-11-09

NORTH RIB

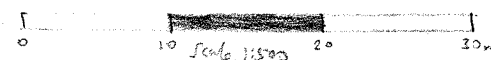

\*Note: Trench fragmented rock in fill, unless specified otherwise.

A2m: 0-13m @ 108°  
13-22m @ 130°  
22-31m @ 096°

### LEGEND

X No sampling possible  
W Water table

### LITHOLOGY:

== Argillite

### Abbreviations:

qt = Quartz  
alt'n = alteration  
wx = weathering

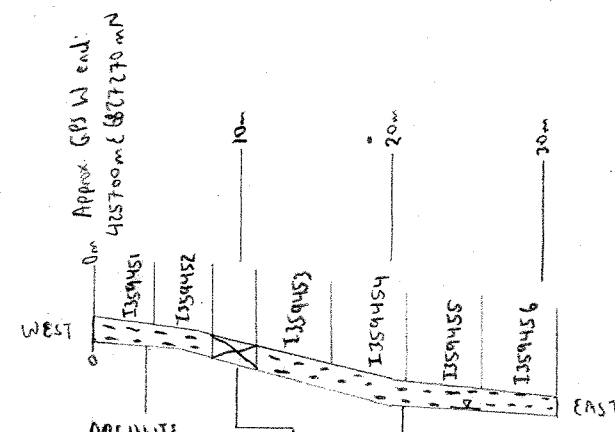

4x Vertical Exaggeration

ARGILLITE  
Finely laminated,  
fissile & flaky.  
Metallic grey, graphite.  
Red/orange alt'n.  
Caliche presence.

@1n: Foliated limonitic  
qt.

@2n: Angular massive qt  
Flatt w/ red & orange  
alt'n - Pink calcitic  
coating.

NO SAMPLE  
Shallow, not  
dug past  
organic  
horizon.

ARGILLITE  
Extensive orange alt'n  
on fractures & wx surfaces.  
Scattered limonitic qt -  
~5% of rocks are foliated  
to massive qt fragments.

@26n: Extensive calcite  
veining.